

GENERAL SPECIFICATION OF HS-65HB MIGHTY FEATHER SERVO

1. TECHNICAL VALUE

CONTROL SYSTEM	:+PULSE WIDTH CONTROL 1500usec NEUTRAL	
OPERATING VOLTAGE RANGE	:4.8V TO 6.0V	
OPERATING TEMPERATURE RANGE	:-20℃ TO +60℃(-68℉ TO +140℉)	
TEST VOLTAGE	:AT 4.8V	AT 6.0V
OPERATING SPEED	:0.16sec/60℄ AT NO LOAD	0.13sec/60℄ AT NO LOAD
STALL TORQUE	:1.6kg.cm(22.21oz.in)	1.9kg.cm(26.38oz.in)
STANDING TORQUE	:1.3kg.cm(18.05oz.in)/5℄ HOLD OUT	1.5kg.cm(20.83oz.in)/5℄ HOLD OUT
IDLE CURRENT	:7.4mA AT STOPPED	7.7mA AT STOPPED
RUNNING CURRENT	:180mA/60℄ AT NO LOAD	220mA/60℄ AT NO LOAD
STALL CURRENT	:960mA	1200mA
DEAD BAND WIDTH	:5usec	5usec
OPERATING TRAVEL	:40℄/ONE SIDE PULSE TRAVELING 400usec	
DIRECTION	:CLOCK WISE/PULSE TRAVELING 1500 TO 1900usec	
MOTOR TYPE	:CORED METAL BRUSH/Nd MAGENT	
POTENTIOMETER TYPE	:2 SLIDER/DIRECT DRIVE	
AMPLIFIER TYPE	:ANALOG S.M.T	
DIMENSIONS	:23.6x11.6x24mm(0.92x0.45x0.94in)	
WEIGHT	:11.2g(0.39oz)	
BALL BEARING	:SINGLE/MR85	
GEAR MATERIAL	:HEAVY DUTY RESIN	
HORN GEAR SPLINE	:25 SEGMENTS/□5	
SPLINED HORNS	:MICRO23:M23-I, M23-X	
CONNECTOR WIRE LENGTH	:250mm(9.84in)	
CONNECTOR WIRE STRAND COUNTER	:20 EA	
CONNECTOR WIRE GAUGE	:28AWG	

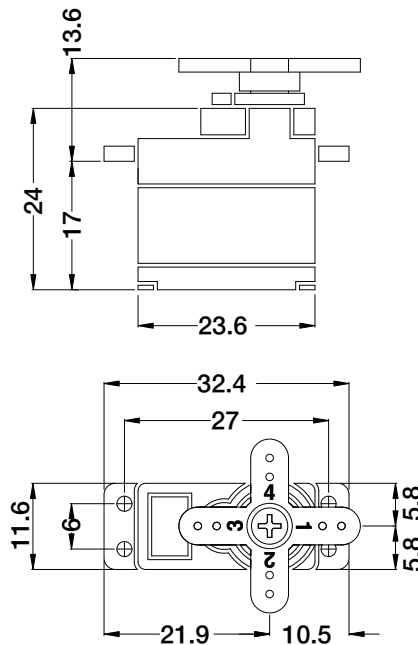

2. FEATURES

HEAVY DUTY RESIN GEARS WITH BALL BEARING
 HIGH EFFICIENCY Nd MAGNET MOTOR

3. APPLICATIONS

FAST PARK FLYING MODELS. ELECTRIC MICRO PLANE, MAV
 1/18 SCALE CARS